

Video Borescope

Model BR150

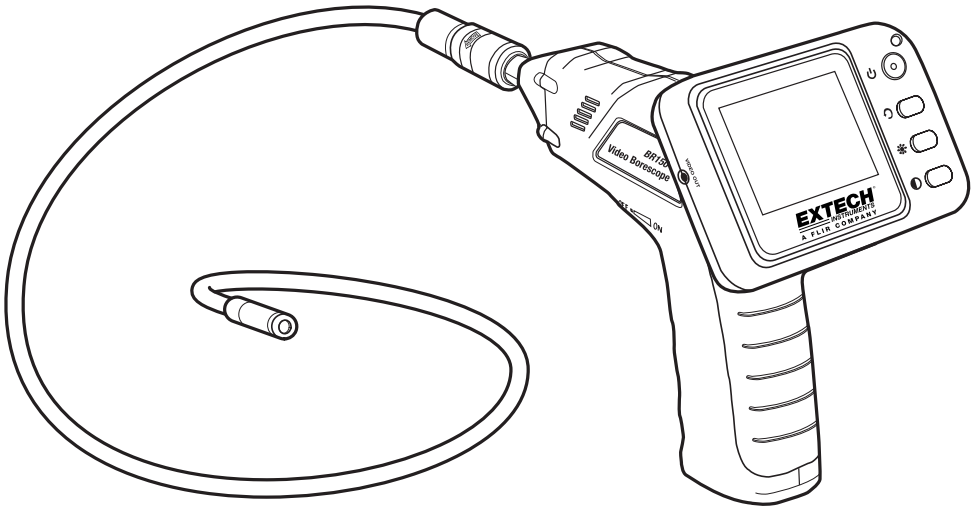

Introduction

Congratulations on your purchase of this Extech BR150 Video Borescope. This instrument was designed for use as an inspection device. It can be used to peer into tight spots and then supply real-time video and images. Typical applications include HVAC inspection, automotive inspection, cable routing, and automotive/boat/aircraft inspection. This meter is shipped fully tested and, with proper use, will provide years of reliable service. Please visit the Extech Instruments website (www.extech.com) to check for the latest version of this User Guide. Extech Instruments is an ISO-9001 certified company.

Description

- 1 Display
- 2 Handle/Battery compartment
- 3 Power On/Off, Dimmer
- 4 Flexible tube
- 5 Camera head and LED's

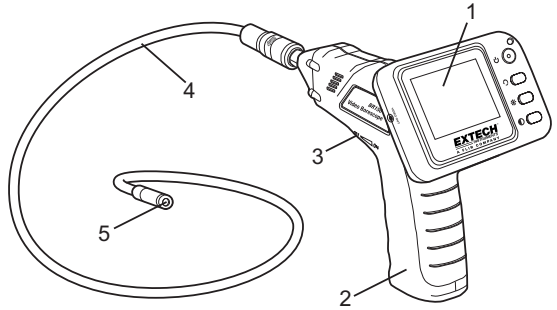

- 1 Power indicator
- 2 Display On/OFF
- 3 Power On/Off (side)
- 4 Image orientation
- 5 Brightness
- 6 Contrast
- 7 Video output
- 8 Handle connector (rear)

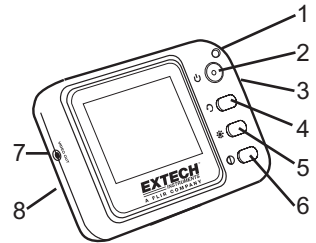

Safety

- Do not expose instrument to moisture
- Shut off the instrument when not in use
- Remove the batteries when cleaning the instrument
- Replace all batteries at the same time

Installation

Install the batteries into the instrument body, charge the monitor battery, connect the camera and flexible tube to the body, and install any accessory as needed.

Battery Installation

1. Remove the screw and cover from the base of the handle.
2. Slide out the battery compartment.
3. Replace the four AA batteries observing polarity
4. Reinstall the battery compartment, cover and screw.

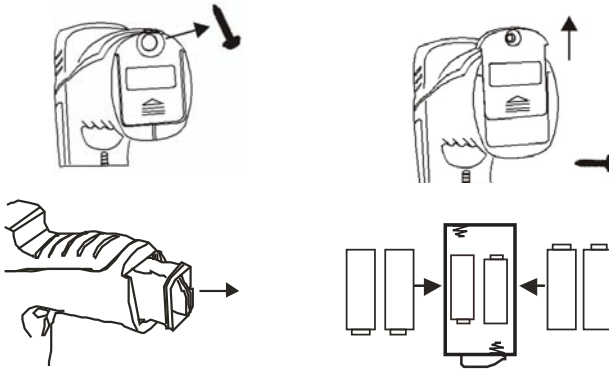

Connect the camera and flexible tube

Connect the camera tube to the instrument body; ensure that the keyed ends are properly aligned. Once aligned, tighten the knurled knob to hold the connection firmly in place.

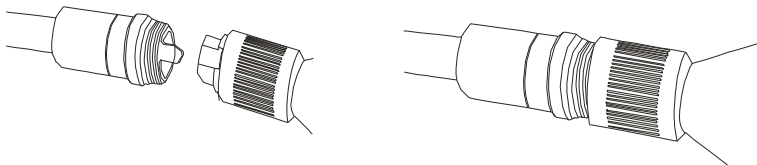

Warning. Permanent damage to the flex tube and loss of operation will occur if the flex tube is subjected to narrow radius or sharp angle bends.

Attaching the Monitor to the instrument body

Insert the connector on the handle into the opening of the connector on the monitor and slide down until the monitor is firmly attached.

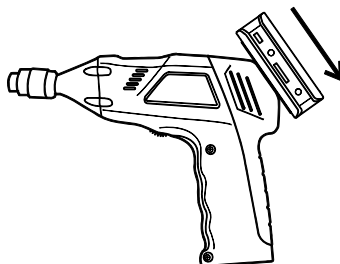

Installing the accessory tools

The included accessories (mirror, hook and magnet) all attach to the camera in the same manner. Refer to the diagrams below:

1. Align the tool as shown in the diagram below at left.
2. Wrap the rubber band ring around the shaft and tool to hold in place as shown in diagram below on right.

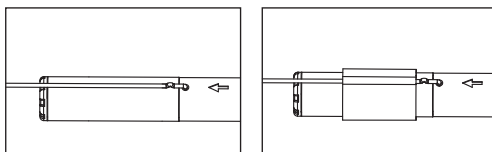

Video Output

Insert the video cable into the VIDEO OUT socket on the monitor. Insert the other end of the cable into the VIDEO IN jack of a TV or other monitor. The LCD Monitor will output a high quality video image.

Battery Replacement

When the battery icon appears on the LCD, the 'AA' battery must be replaced. The battery compartment is located on the bottom of the meter.

1. Press in and down on the arrow located above the tilt stand hinge.
2. Replace the 9V battery.
3. Replace the battery cover.

Battery Safety Reminders

- Please dispose of batteries responsibly; always observe local, state, and federal regulations with regard to battery disposal.
- Never dispose of batteries in a fire. Batteries may explode or leak.
- Never mix battery types. Always install new batteries of the same type.

Operation

1. Rotate the ON/OFF dial switch to power the camera. The power indicator on the top of the handle will switch on.
2. Further rotation of the switch adjusts the intensity of the two LEDs on the camera head.
3. Slide the On/Off switch on the side of the monitor to the ON position
4. Press the power button on the face of the monitor. The power light will turn on and the picture will appear.
5. Press the orientation button on the face of the monitor to rotate the picture as needed.
6. Press the brightness and contrast buttons in conjunction with the rotating the LED intensity for the best image quality.
7. The tube can be easily maneuvered into position. The tube can be bent into the shape of the area to be examined.
8. Use the supplied accessories to help retrieve small items.

Specifications

CAMERA

Imaging Sensor	CMOS
Total Pixels	712×486 (NTSC)
Horizontal View Angle	45 degree
Transmission Frequency	2468MHz
Minimum Illumination	0 Lux
Power Supply	4 x AA batteries
LCD Screen Type	2.36" TFT-LCD
Effective Pixels	480 x 234
Video Output Level	0.9-1.3VP-P@75Ω
Receiving Sensitivity	≤-85dBm
Dimensions (Monitor)	(W x D x H) 3.9 x 2.8 x 1.2" (100 x 70 x 30mm)
Operating Humidity (Max.)	15~85%RH
Waterproof Capacity	IP67 (imager head only)
Dimensions (Handle)	(W x D x H) 7.3 x 5.7 x 1.6" (186 x 145 x 41mm) (Excluding Flexible Tube)
Weight (approx)	15.5 oz. (440g)
Camera head Diameter	0.35" (9mm)
Operating Temperature	+14°F~-+122°F (-10°C~-+50°C)

Warranty

EXTECH INSTRUMENTS CORPORATION (a FLIR company) warrants this instrument to be free of defects in parts and workmanship for **one year** from date of shipment (a six month limited warranty applies to sensors and cables). If it should become necessary to return the instrument for service during or beyond the warranty period, contact the Customer Service Department for authorization. Visit our website www.extech.com for contact information. A Return Authorization (RA) number must be issued before any product is returned to Extech. The sender is responsible for shipping charges, freight, insurance and proper packaging to prevent damage in transit. This warranty does not apply to defects resulting from action of the user such as misuse, improper wiring, operation outside of specification, improper maintenance or repair, or unauthorized modification. Extech specifically disclaims any implied warranties or merchantability or fitness for a specific purpose and will not be liable for any direct, indirect, incidental or consequential damages. Extech's total liability is limited to repair or replacement of the product. The warranty set forth above is inclusive and no other warranty, whether written or oral, is expressed or implied.

Calibration and Repair Services

Extech offers repair and calibration services for the products we sell. Extech also provides NIST certification for most products. Call the Customer Service Department for information on calibration services available for this product. Extech recommends that annual calibrations be performed to verify meter performance and accuracy.

Support lines: U.S. 877-439-8324, Intl. +1 603-324-7800
Technical support: Option 3; E-mail: support@extech.com
Repair & Returns: Option 4; E-mail: repair@extech.com
Product specifications subject to change without notice
Visit our website: www.extech.com
Extech Instruments Corporation, 9 Townsend West, Nashua, NH 03063
ISO 9001 Certified since 1995

Copyright © 2012 Extech Instruments Corporation (a FLIR company)

All rights reserved including the right of reproduction in whole or in part in any form

Garantie

EXTECH INSTRUMENTS CORPORATION (une société FLIR) garantit que cet instrument est exempt de défectuosité ou de défaut de fabrication pendant une période d'un an à compter de la date de livraison (une garantie limitée de six mois est applicable pour les sondes et les câbles). S'il s'avère nécessaire de retourner l'instrument pour un dépannage durant ou après la période de garantie, contactez le service à la clientèle pour obtenir une autorisation de retour. Visitez notre site Web au www.extech.com pour des informations. Un numéro d'autorisation de retour (AR) doit être émis avant que tout produit puisse être retourné à Extech. L'expéditeur est responsable des frais d'expédition, de transport, d'assurance et d'emballage adéquat afin de prévenir les dommages durant le transit. Cette garantie ne s'applique pas aux défauts résultant d'une action de l'utilisateur tels un mauvais usage, un câblage adéquat, un fonctionnement hors des spécifications, un entretien ou un dépannage inadéquat, ou une modification non autorisée. Extech décline précisément toute garantie implicite ou garantie marchande ou d'adaptation à un usage particulier et ne pourra être tenu responsable d'aucun dommage direct, indirect, accidentel ou consécutif. La responsabilité totale d'Extech se limite à la réparation ou au remplacement du produit. La garantie énoncée ci-dessus est inclusive et aucune autre garantie, qu'elle soit écrite ou orale, n'est stipulée ou sous-entendue.

Service de calibrage et de réparation

Extech offre un service de calibrage et de réparation pour toute sa gamme de produits. Extech fournit également une certification NIST pour la plupart de ses produits. Contactez le Service Clients pour de plus amples informations concernant les services de calibrage disponibles pour ce produit. Extech vous recommande de procéder à un test de calibrage annuel afin de vérifier régulièrement les performances et la précision de votre appareil.

Appui de produit U.S. 877-439-8324, Intl. +1 603-324-7800
Service d'assistance technique: l'option 3, email : support@extech.com
Réparations et retours : l'option 4, email : repair@extech.com
Spécifications produit sujettes à modifications sans préavis
www.extech.com
Extech Instruments Corporation, 9 Townsend West, Nashua, NH 03063
ISO 9001 Certified since 1995

Copyright © 2012 Extech Instruments Corporation (a FLIR company)

Tous droits réservés, y compris le droit de reproduction, en tout ou en partie, sous quelque forme que ce soit.

Garantía

EXTECH INSTRUMENTS CORPORATION (una empresa FLIR) garantiza este instrumento libre de defectos en partes o mano de obra durante **un año** a partir de la fecha de embarque (se aplica una garantía limitada a seis meses para los cables y sensores). Si fuera necesario regresar el instrumento para servicio durante o después del período de garantía, llame al Departamento de Servicio a Clientes para autorización. Visite nuestra página en Internet www.extech.com para Información de contacto. Se debe otorgar un número de Autorización de Retorno (RA) antes de regresar cualquier producto a Extech. El remitente es responsable de los gastos de embarque, flete, seguro y empaque apropiado para prevenir daños en tránsito. Esta garantía no se aplica a defectos resultantes de las acciones del usuario como el mal uso, alambrado equivocado, operación fuera de las especificaciones, mantenimiento o reparación inadecuada o modificación no autorizada. Extech específicamente rechaza cualesquier garantías implícitas o factibilidad de comercialización o aptitud para cualquier propósito determinado y no será responsable por cualesquier daños directos, indirectos, incidentales o consecuentes. La responsabilidad total de Extech está limitada a la reparación o reemplazo del producto. La garantía precedente es inclusiva y no hay otra garantía ya sea escrita u oral, expresa o implícita.

Servicios de reparación y calibración

Extech ofrece servicios completos de reparación y calibración para todos los productos que vendemos. Extech además provee certificación NIST para la mayoría de los productos. Llame al Departamento de Servicio al Cliente para solicitar información de calibración para este producto. Extech recomienda realizar calibraciones anuales para verificar el desempeño y precisión del medidor.

Ayuda de producto: U.S. 877-439-8324, Intl. +1 603-324-7800

Soporte Técnico Opción 3, e-mail support@extech.com

Reparación / Retornos: Opción 4, e-mail repair@extech.com

Las especificaciones del producto están sujetas a cambios sin aviso

Visite nuestro sitio web www.extech.com

Extech Instruments Corporation, 9 Townsend West, Nashua, NH 03063

ISO 9001 Certified since 1995

Copyright © 2012 Extech Instruments Corporation (a FLIR company)

Reservados todos los derechos, incluyendo el derecho de reproducción total o parcial en cualquier medio.