

Installation

S19-270BL

Swing-Away Eyewash

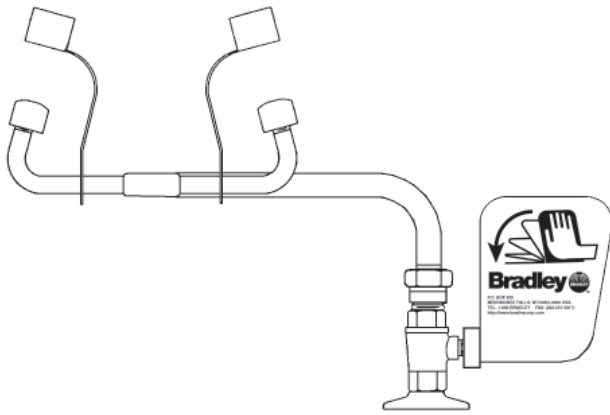
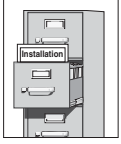

Table of Contents

Pre-Installation Information	2
Installation Instructions	3
Assembly of Components	4
Parts List	4

⚠ IMPORTANT ⚠



Read this installation manual completely to ensure proper installation, then file it with the owner or maintenance department. Compliance and conformity to drain requirements and other local codes and ordinances is the responsibility of the installer.



Separate parts from packaging and make sure all parts are accounted for before discarding any packaging material. If any parts are missing, do not begin installation until you obtain the missing parts.



Flush the water supply lines before beginning installation and after installation is complete. Test the unit for leaks and adequate water flow. Main water supply to the eyewash should be "ON" at all times. Provisions shall be made to prevent unauthorized shutoff.



The ANSI Z358.1 standard requires an uninterrupted supply of flushing fluid at a minimum 30 PSI (0.21 MPa) flowing pressure. Flushing fluid should be tepid per ANSI Z358.1.



The inspection and testing results of this equipment should be recorded weekly to verify proper operation. This equipment should be inspected annually to ensure compliance with ANSI Z358.1.



Workers who may come in contact with potentially hazardous materials should be trained regarding the placement and proper operation of emergency equipment per ANSI Z358.1.



For questions regarding the operation or installation of this product, visit www.bradleycorp.com or call 1-800-BRADLEY.

Product warranties may also be found under "Product Information" on our web site at www.bradleycorp.com.

Installation

Supplies Required:

- Pipe sealant
- Piping to 1/2" NPT water supply inlet on unit
- Sign-mounting hardware

NOTE: Local codes may require the installation of a backflow prevention valve to complete proper installation. Compliance with local codes is the responsibility of the installer. Valve must be tested annually to verify that it is functioning properly. Backflow prevention valves are not included with the fixture and may be supplied by the contractor or purchased from Bradley Corporation.

Step 1: Attach eyewash

NOTE: The top of the eyewash heads should be positioned a maximum of 45" from the floor.

1. Select the desired location for the eyewash on the sink deck and drill a 7/8" diameter hole.
2. Secure the assembled unit to the deck with the nuts and washers provided as shown on page 4.

Step 2: Connect water supply

1. Connect the water supply using 1/4" nominal (3/8" O.D.) copper tubing (supplied by installer), the friction ring, seal washer and nut provided.
2. Mount the safety sign to wall or pipe using sign-mounting hardware supplied by installer.
3. Open the water supply lines. Test for leaks and adequate water flow.

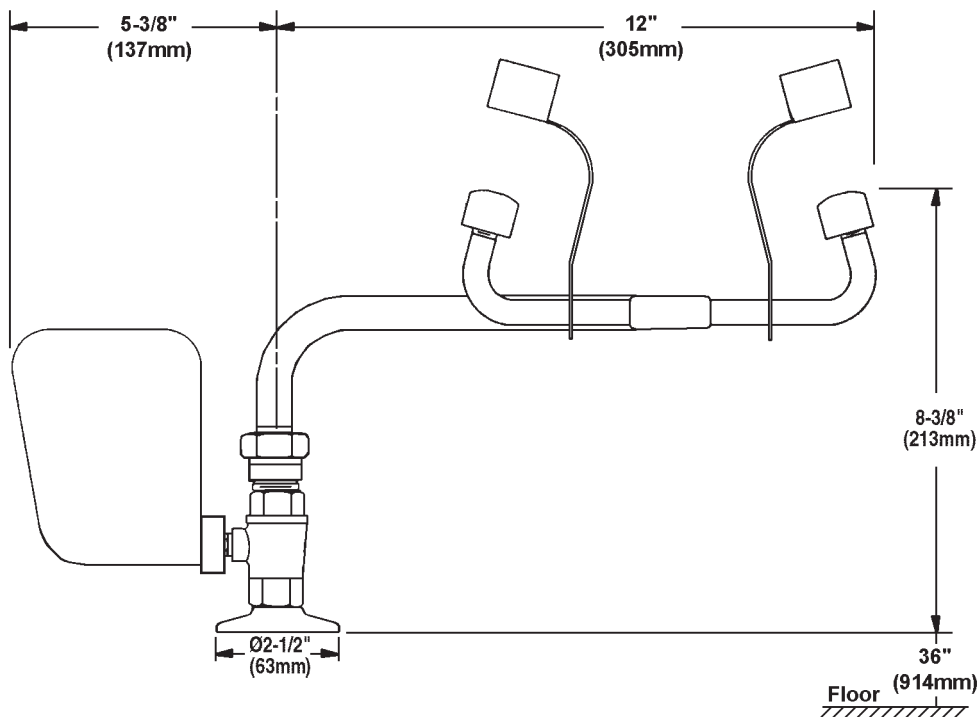

Assembly of Components and Parts List

NOTE: The eyewash comes preassembled.

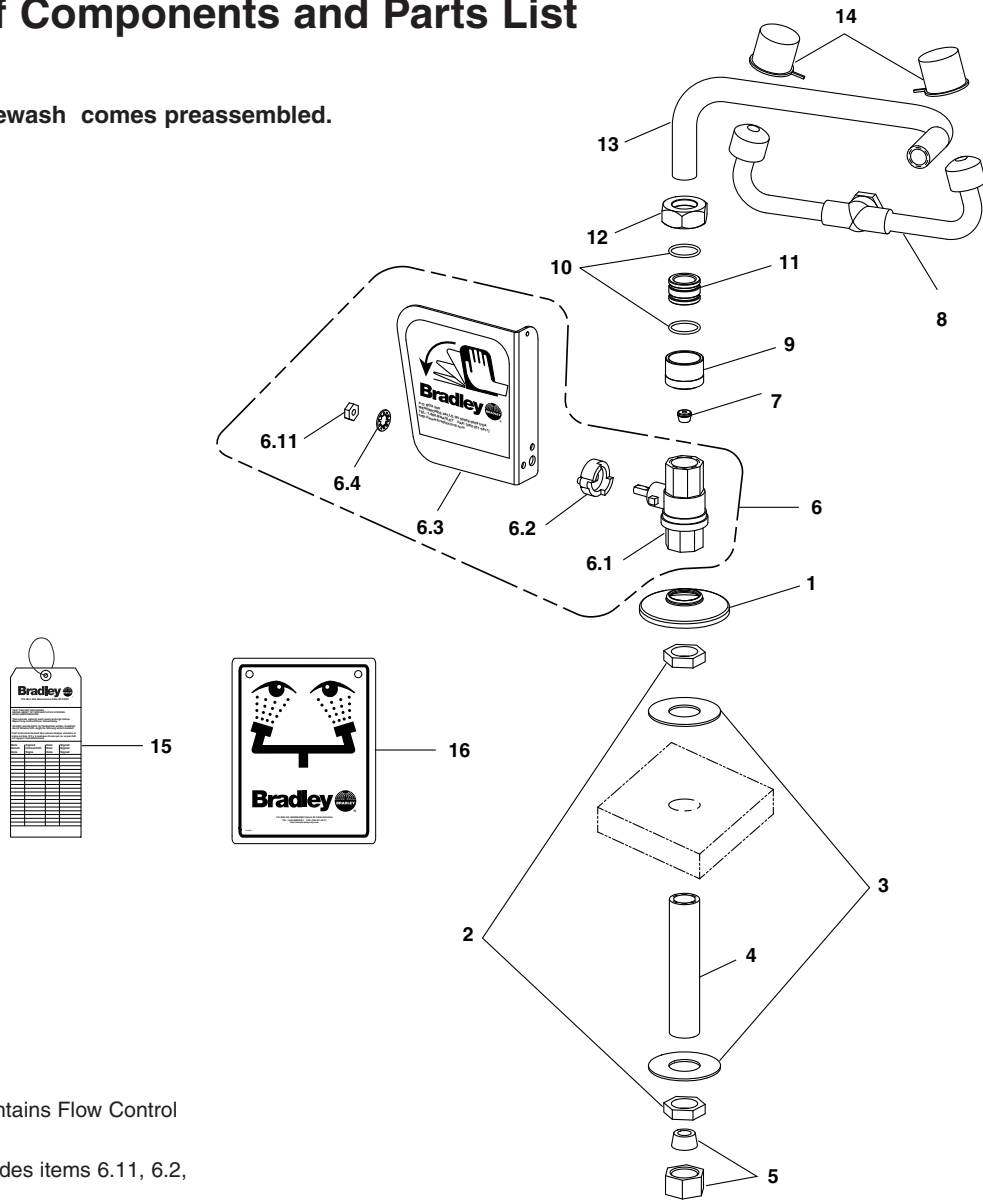

Repair Kit S65-118 contains Flow Control and Swivel Body
 Prepack S30-075 includes items 6.11, 6.2, 6.3, 6.4

Item	Part No.	Qty	Description	Item	Part No.	Qty	Description
1	300-0375	1	Flange	7	125-164	1	Flow Control
2	110-115	2	Nut 1/2"-14 NPSM	8	S05-092	1	Eyewash Yoke Assembly
3	142-002CB	2	Washer	9	153-344	1	Swivel Body
4	113-1058	1	Shank	10	125-001DC	2	O-Ring
5	S45-381	1	Slip Joint Prepack	11	122-018	1	Swivel
6	S30-074	1	1/2" Valve/Handle Prepack	12	110-217	1	Nut, Tailpiece
6.1	S27-282	1	1/2" Ball Valve w/Nut	13	113-860	1	Bent Pipe
6.11	110-215	1	Nut Only	14	107-371	2	Tethered Dust Cover
6.2	153-372L	1	Ball Valve Adapter	15	204-421	1	Emergency Inspection Tag
6.3	S08-0576	1	Handle Assembly	16	114-051	1	Safety Sign
6.4	142-002DA	1	Lockwasher				